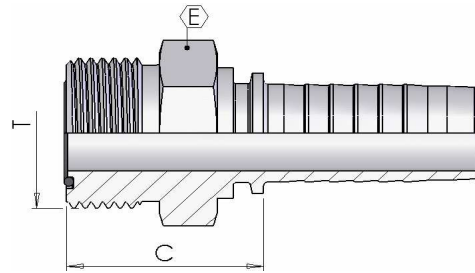

● ● ● ● ● ● Ниппель стандартный / Standard tail

Страница / Page	63	63	64	65	62
	S050 ORFS FEMALE	S05T FEMALE back Hexagon	S150 90° Swept Elbow	S250 45° Swept Elbow	S350 ORFS MALE
	ORFS	ORFS	ORFS 90°	ORFS 45°	ORFS
	66	67	67		66

Dimensions and general characteristics may be changed at any time without prior notice.

Data contained herein are for information purpose only, and it does not enlarge, amend or imply any warranty other than provided by us with the product
Any use of the product not in conformance with our instructions may be dangerous.

S350 Штуцер ORFS
(ORFS) ORFS Male

part number	hose I.D.		Dimension			
			dash size	thread	hex	cut-off
	in	mm		T	E	C
S350-04-06	1/4	6,4	04	9/16-18	17	23
S350-04-09	1/4	6,4	04	11/16-16	19	21
S350-05-09	5/16	7,9	05	11/16-16	19	26
S350-06-09	3/8	9,5	06	11/16-16	19	26
S350-06-11	3/8	9,5	6	13/16-16	22	29
S350-08-11	1/2	12,7	08	13/16-16	22	29
S350-08-13	1/2	12,7	08	1-14	27	34
S350-08-14	1/2	12,7	08	1.3/16-12	32	35
S350-10-13	5/8	15,9	10	1-14	27	33
S350-10-14	5/8	15,9	10	1.3/16-12	32	35
S350-12-14	3/4	19	12	1.3/16-12	32	36
S350-12-15	3/4	19	12	1.7/16-12	38	36
S350-16-15	1	25,4	16	1.7/16-12	38	37
S350-16-21	1	25,4	16	1.11/16-12	46	38
S350-20-21	1.1/4	31,8	20	1.11/16-12	46	39

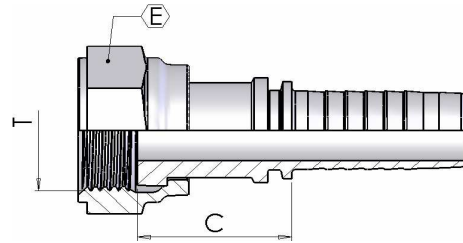
S050 Ниппель ORFS
(ORFS) ORFS Female

part number	hose I.D.		Dimension			
	in	mm	dash size	thread T	hex E	cut-off C
S050-04-06	1/4	6,4	04	9/16-18	19	25
S050-04-09	1/4	6,4	04	11/16-16	22	29
S050-04-11	1/4	6,4	04	13/16-16	24	32
S050-05-09	5/16	7,9	05	11/16-16	22	29
S050-06-09	3/8	9,5	06	11/16-16	22	29
S050-06-11	3/8	9,5	06	13/16-16	24	30
S050-08-11	1/2	12,7	08	13/16-16	24	32
S050-08-13	1/2	12,7	08	1-14	30	35
S050-08-14	1/2	12,7	08	1.3/16-12	36	37
S050-10-13	5/8	15,9	10	1-14	30	35
S050-10-14	5/8	15,9	10	1.3/16-12	36	34
S050-12-13	3/4	19	12	1-14	30	37
S050-12-14	3/4	19	12	1.3/16-12	36	35
S050-12-15	3/4	19	12	1.7/16-12	41	41
S050-16-15	1	25,4	16	1.7/16-12	41	39
Съемная гайка S050-20-21	1.1/4	31,8	20	1.11/16-12	50	40
Съемная гайка S050-24-32	1.1/2	38,1	24	2-12	60	41

 Съемная гайка
 Съемная гайка

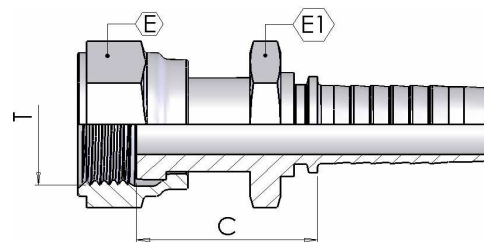
S05T Ниппель ORFS контргайка
(ORFS) ORFS Female Back Hexagon

part number	hose I.D.		Dimension				
	in	mm	dash size	thread T	hex E	hex E1	cut-off C
S05T-04-06	1/4	6,4	04	9/16-18	19	15	30
S05T-06-09	3/8	9,5	06	11/16-16	22	17	34
S05T-08-11	1/2	12,7	08	13/16-16	24	19	37
S05T-10-13	5/8	15,9	10	1-14	30	24	41
S05T-12-14	3/4	19	12	1.3/16-12	36	30	42
S05T-16-15	1	25,4	16	1.7/16-12	41	36	50

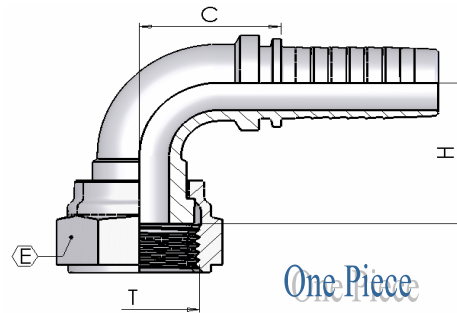
S150 Ниппель ORFS 90°
(ORFS 90°) ORFS 90° Swept Elbow

part number	hose I.D.		Dimension				
	in	mm	dash size	thread T	hex E	drop H	cut-off C
S150-04-06	1/4	6,4	04	9/16-18	19	26	25
S150-04-09	1/4	6,4	04	11/16-16	22	23	25
S150-05-09	5/16	7,9	05	11/16-16	22	32	29
S150-06-09	3/8	9,5	06	11/16-16	22	33	33
S150-06-11	3/8	9,5	06	13/16-16	24	32	33
S150-08-11	1/2	12,7	08	13/16-16	24	36	39
S150-08-13	1/2	12,7	08	1-14	30	40	39
S150-08-14	1/2	12,7	08	1.3/16-12	36	39	42
S150-10-13	5/8	15,9	10	1-14	30	39	47
<i>приварной</i> S150-10-14	5/8	15,9	10	1.3/16-12	36	39	42
<i>приварной</i> S150-12-13	3/4	19	12	1-14	30	39	42
S150-12-14	3/4	19	12	1.3/16-12	36	49	57
S150-12-15	3/4	19	12	1.7/16-12	41	51	56
S150-16-15	1	25,4	16	1.7/16-12	41	62	67
<i>приварной</i> S150-16-21	1	25,4	20	1.11/16-12	50	58	62
<i>приварной</i> S150-20-21	1.1/4	31,8	20	1.11/16-12	50	58	63
<i>приварной</i> S150-24-32	1.1/2	38,1	24	2-12	60	73	80

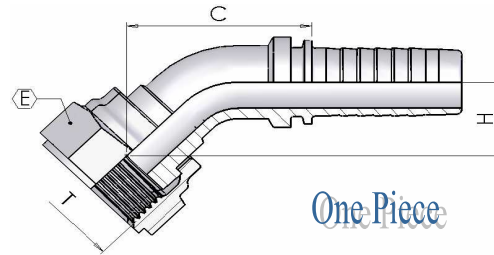
S250 Ниппель ORFS 45°
(ORFS 45°) ORFS 45° Swept Elbow

part number	hose I.D.		Dimension				
	in	mm	dash size	thread T	hex E	drop H	cut-off C
S250-04-06	1/4	6,4	04	9/16-18	19	14	40
S250-04-09	1/4	6,4	04	11/16-16	22	14	38
S250-05-09	5/16	7,9	05	11/16-16	22	14	44
S250-06-09	3/8	9,5	06	11/16-16	22	17	52
S250-06-11	3/8	9,5	06	13/16-16	24	18	51
S250-08-11	1/2	12,7	08	13/16-16	24	20	62
S250-08-13	1/2	12,7	08	1-14	30	23	64
S250-08-14	1/2	12,7	08	1.3/16-12	36	23	62
S250-10-13	5/8	15,9	10	1-14	30	22	67
<i>приварной</i> S250-10-14	5/8	15,9	10	1.3/16-12	36	18	44
<i>приварной</i> S250-12-13	3/4	19	12	1-14	30	15	40
S250-12-14	3/4	19	12	1.3/16-12	36	23	84
S250-12-15	3/4	19	12	1.7/16-12	41	26	84
S250-16-15	1	25,4	16	1.7/16-12	41	31	100
<i>приварной</i> S250-20-21	1.1/4	31,8	20	1.11/16-12	50	44	125
<i>приварной</i> S250-24-32	1.1/2	38,1	24	2-12	60	29	78

● ● ● ● ● ● **Ниппель Inter-lock / Inter-lock tail**

Страница / Page

11

12

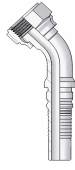

S250H

45° Swept Elbow

ORFS-45°

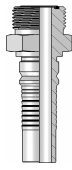

S350H

ORFS Male

ORFS

S050H Ниппель ORFS

(ORFS) ORFS Female

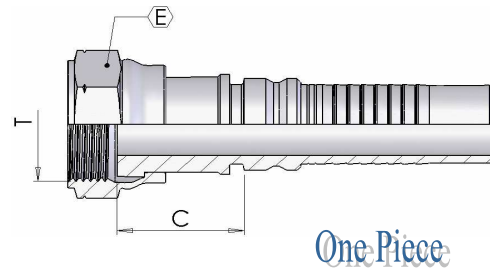

One Piece

Съемная гайка

part number	hose I.D.		Dimension				
			dash size	thread	hex		cut-off
	in	mm		T	E	E	C
S050H12-14	3/4	19	12	1.3/16-12	36		33
S050H16-15	1	25,4	16	1.7/16-12	41		37
S050H20-21	1.1/4	31,8	20	1.11/16-12	50		37
S050H24-32	1.1/2	38,1	24	2-12	60		41

S05TH Ниппель ORFS контргайка

(ORFS) ORFS Female Back Hexagon

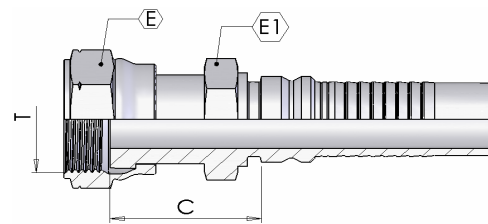

One Piece

part number	hose I.D.		Dimension				
			dash size	thread	hex		
	in	mm		T	E	E1	C
S05TH12-14	3/4	19	12	1.3/16-12	36	30	39
S05TH16-15	1	25,4	16	1.7/16-12	41	36	47
S05TH20-21	1.1/4	31,8	20	1.11/16-12	50	46	50
S05TH24-32	1.1/2	38,1	24	2-12	60	50	53

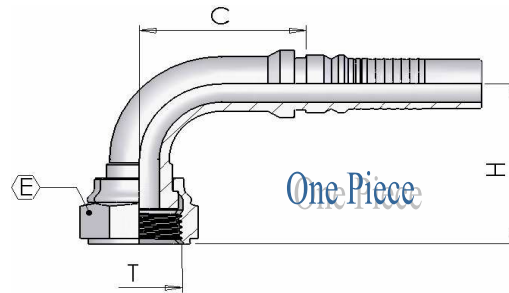
S150H Ниппель ORFS 90°
(ORFS 90°) ORFS 90° Swept Elbow

Съемная гайка

part number	hose I.D.		Dimension				
	in	mm	dash size	thread T	hex E	drop H	cut-off C
S150H12-14	3/4	19	12	1.3/16-12	36	49	54
S150H16-15	1	25,4	16	1.7/16-12	41	66	69
S150H20-21	1.1/4	31,8	20	1.11/16-12	50	80	87
S150H24-32	1.1/2	38,1	24	2-12	60	102	111

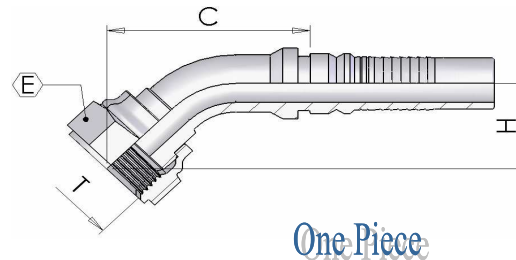
S250H Ниппель ORFS 45°
(ORFS 45°) ORFS 45° Swept Elbow

Съемная гайка

part number	hose I.D.		Dimension				
	in	mm	dash size	thread T	hex E	drop H	cut-off C
S250H12-14	3/4	19	12	1.3/16-12	36	23	84
S250H16-15	1	25,4	16	1.7/16-12	41	33	107
S250H20-21	1.1/4	31,8	20	1.11/16-12	50	37	130
S250H24-32	1.1/2	38,1	24	2-12	60	50	165

S350H Штуцер ORFS

(ORFS) ORFS Male

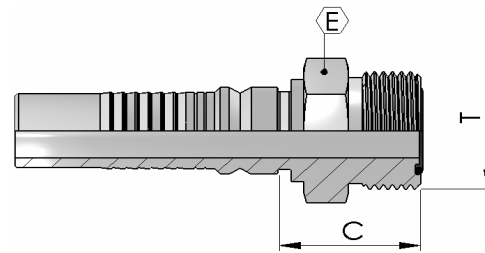

part number	hose I.D.		Dimension			
			dash size	thread	hex	cut-off
	in	mm		T	E	C
S350H12-14	3/4	19	12	1.3/16-12	32	34
S350H16-15	1	25,4	16	1.7/16-12	38	35
S350H20-21	1.1/4	31,8	20	1.11/16-12	46	36
S350H24-32	1.1/2	38,1	24	2-12	50	45